

# USER MANUAL

# *ProLite*

## LCD Monitor

ENGLISH

*ProLite LH9252UWS*  
*ProLite LH10552UWS*

Thank you very much for choosing the iiyama LCD monitor.

We recommend that you take a few minutes to read this comprehensive manual carefully before installing and switching on the monitor. Please keep this manual in a safe place for your future reference.



**Dear user, we congratulate you on the purchase of your iiyama LCD.**

For details on warranty and locally used pixel policies that apply directly after installation of your product please check the iiyama website.

**To report a fault, please contact your local support centre found at <https://iiyama.com>**

**Things to check before you call the iiyama information line**

- | if the power cable is connected securely and turned on?
- | if the display has been turned on?
- | if the signal cable is connected securely and the correct input selected?
- | if the computer has been restarted with the display connected?
- | if the graphics card is correctly installed with the latest drivers possible?
- | if the correct native resolution has been selected via 'Display Properties'?
- | If the R/G/B signal configuration is correct?
- | if the displays On Screen Menu is shown?
- | if the correct brightness and contrast settings have been set?
- | if given display tolerances and compatibility have been considered?
- | if via the On Screen Menu you have performed a Factory Reset/Recall?

**Before reporting the screen defect, please prepare the following information/evidence:**

- | model number \*
- | purchase receipt and serial number \*
- | name and address for collection
- | telephone/fax number, for availability during the day
- | convenient collection date (date, time)
- | short description of the defect

**Important Note:**

If there is no fault found in the collected equipment after inspection, the transferring party shall incur charges for transport and administration.

If you have checked all of the above and there is still no picture, call our information line for assistance in your country.

**Feedback on health and safety issues**

If you have any health and safety concerns or questions about the product (including when using the product), please contact iiyama support through our website. You can also contact us by calling +31 204460404. After receiving your feedback, we will ask the responsible unit to handle it as soon as possible and a dedicated person will get back to you. Your feedback will also be recorded and incorporated into our evaluation for improvements

\* see the identification plate on the back of the case.

## CE MARKING DECLARATION OF CONFORMITY

This LCD monitor complies with the requirements of the EC/EU Directive 2014/30/EU "EMC Directive", 2014/35/EU "Low Voltage Directive", 2009/125/EC "ErP Directive" and 2011/65/EU "RoHS Directive".

The electro-magnetic susceptibility has been chosen at a level that gives correct operation in residential areas, business and light industrial premises and small-scale enterprises, inside as well as outside of the buildings. All places of operation are characterised by their connection to the public low voltage power supply system.

IYAMA CORPORATION: Taurusavenue 187, 2132 LS Hoofddorp, The Netherlands

Model No. : PL9252U, PL10552U



We recommend recycling of used product. Please contact your dealer or iiyama service center. Recycle information is obtained via the Internet, using the address: <https://iiyama.com>

You can access the Web page of different countries from there.

- We reserve the right to change specifications without notice.
- All trademarks used in this user manual are the property of their respective owners.
- Eprel registration number LH9252UWS-B1AG : 2608231, LH10552UWS-B1AG : 2607910

**⚠ WARNING**

**THIS PRODUCT CONTAINS TWO AAA ALKALINE BATTERIES.**



Do not heat batteries.

Do not deform battery.

Do not recharge battery.

Do not dispose of battery in fire.

Keep battery away from direct sunlight and heat sources, do not storage in high temperature and humidity environment.

Do not ingest battery, Chemical Burn Hazard.

Keep new and used batteries away from children.

If the battery compartment does not close securely, stop using the product and keep it away from children

If you think batteries might have been swallowed or placed inside any part of the body, seek immediate medical attention.

ENGLISH

Battery Model	LR03
Battery Voltage/Typical Capacity	1.5 V, 1200 mAh
Battery Manufacturer	TP Vision Europe B.V. Prins Bernhardplein 200, 1097 JB Amsterdam, The Netherlands



Please inform yourself about the local separate collection system for electrical and electronic products.

Please act according to your local rules and do not dispose of your old products with your normal household waste. Correct disposal of your old products helps to prevent potential negative consequences for the environment and human health.

Your product contains batteries covered by the European Regulation (EU) 2023/1542, which cannot be disposed with normal household waste. Alternatively, please visit [https://iijama.com/gl\\_en/support/#recycling](https://iijama.com/gl_en/support/#recycling)

# TABLE OF CONTENTS

FOR YOUR SAFETY.....	1
SAFETY PRECAUTIONS.....	1
SPECIAL NOTES ON LCD MONITORS .....	3
CUSTOMER SERVICE .....	5
CLEANING .....	5
BEFORE YOU OPERATE THE MONITOR.....	6
FEATURES.....	6
CHECKING THE CONTENTS OF THE PACKAGE .....	6
UNPACKING .....	7
INSTALLATION .....	8
CONTROLS AND CONNECTORS : MONITOR.....	9
FUNCTIONS OF THE REMOTE CONTROL .....	12
PREPARING THE REMOTE CONTROL.....	13
BASIC OPERATION.....	15
CONNECTING YOUR MONITOR.....	18
COMPUTER SETTING .....	21
OPERATING THE MONITOR.....	22
ADJUSTMENT MENU CONTENTS.....	24
STANDBY FEATURE .....	34
TROUBLE SHOOTING .....	35
RECYCLING INFORMATION.....	36
APPENDIX .....	37
SPECIFICATIONS : ProLite LH9252UWS-B1AG.....	37
SPECIFICATIONS : ProLite LH10552UWS-B1AG .....	39
DIMENSIONS : ProLite LH9252UWS .....	41
DIMENSIONS : ProLite LH10552UWS .....	41
COMPLIANT TIMING .....	42

# FOR YOUR SAFETY

## SAFETY PRECAUTIONS

### WARNING

#### **STOP OPERATING THE MONITOR WHEN YOU SENSE TROUBLE**

If you notice any abnormal phenomena such as smoke, strange sounds or fumes, unplug the monitor and contact your dealer or iiyama service center immediately. Further use may be dangerous and can cause fire or electric shock.

#### **NEVER REMOVE THE CABINET**

High voltage circuits are inside the monitor. Removing the cabinet may expose you to the danger of fire or electric shock.

#### **DO NOT PUT ANY OBJECT INTO THE MONITOR**

Do not put any solid objects or liquids such as water into the monitor. In case of an accident, unplug your monitor immediately and contact your dealer or iiyama service center. Using the monitor with any object inside may cause fire, electric shock or damage.

#### **INSTALL THE MONITOR ON A FLAT, STABLE SURFACE**

The monitor may cause an injury if it falls or is dropped.

#### **DO NOT USE THE MONITOR NEAR WATER**

Do not use where water may be splashed or spilt onto the monitor as it may cause fire or electric shock.

#### **OPERATE UNDER THE SPECIFIED POWER SUPPLY**

Be sure to operate the monitor only with the specified power supply. Use of an incorrect voltage will cause malfunction and may cause fire or electric shock.

#### **PROTECT THE CABLES**

Do not pull or bend the power cable and signal cable. Do not place the monitor or any other heavy objects on the cables. If damaged, the cables may cause fire or electric shock.

#### **ADVERSE WEATHER CONDITIONS**

It is advisable not to operate the monitor during a heavy thunder storm as the continual breaks in power may cause malfunction. It is also advised not to touch the plug in these circumstances as it may cause electric shock.

#### **REINSTALL THE OPS COVER SECURELY**

Ensure the OPS cover is securely reinstalled and fastened after any internal access or maintenance.

## CAUTION

### INSTALLATION LOCATION

Do not install the monitor where sudden temperature changes may occur, or in humid, dusty or smoky areas as it may cause fire, electric shock or damage. You should also avoid areas where the sun shines directly on the monitor.

### DO NOT PLACE THE MONITOR IN A HAZARDOUS POSITION

The monitor may topple and cause injury if not suitably located. Please also ensure that you do not place any heavy objects on the monitor, and that all cables are routed such that children may not pull the cables and possibly cause injury.

### MAINTAIN GOOD VENTILATION

Ventilation slots are provided to keep the monitor from overheating. Covering the slots may cause fire. To allow adequate air circulation, place the monitor at least 10 cm (or 4 inches) from any walls. Operating the monitor on its back, side, upside down or on a carpet or any other soft material may also cause damage.

### DISCONNECT THE CABLES WHEN YOU MOVE THE MONITOR

When you move the monitor, turn off the power switch, unplug the monitor and be sure the signal cable is disconnected. If you do not disconnect them, it may cause fire or electric shock.

### UNPLUG THE MONITOR

If the monitor is not in use for a long period of time it is recommended that it is left unplugged to avoid accidents.

### HOLD THE PLUG WHEN DISCONNECTING

To disconnect the power cable or signal cable, always pull it by the plug. Never pull on the cable itself as this may cause fire or electric shock.

### DO NOT TOUCH THE PLUG WITH WET HANDS

Pulling or inserting the plug with wet hands may cause electric shock.

## SPECIAL NOTES ON LCD MONITORS

- The following symptoms are normal with LCD monitors and do not indicate a problem.

### NOTE

- When you first turn on the LCD monitor, the picture may not fit in the display area because of the type of computer that is used. In this case, adjust the picture position to the correct position.
- You may find slightly uneven brightness on the screen depending on the desktop pattern you use.
- Due to the nature of the LCD screen, an afterimage of the previous screen may remain after switching the image, when the same image is displayed for hours. In this case, the screen is recovered slowly by changing the image or turning off the Power Switch for hours.

- This LCD cannot be used outdoors.
- This LCD cannot be used with the screen facing upwards.
- If you use a cable longer than the supplied one, the picture quality is not guaranteed.

## USAGE CONFIRMATION

Product maximum non-stop usage hours following the installation guidelines in a clean and temperature-controlled environment: 24/7

The monitor is compatible for usage in Landscape/Portrait applications.

## IMAGE PERSISTENCE / IMAGE STICKING

Please be aware that all LCD screens can experience Image Persistence or Image Sticking. This occurs when a residual image remains visible on a screen when static images are displayed for long periods of time. LCD Image Persistence is not permanent but constant images being displayed for a long period of time should be avoided.

To counteract Image Persistence, turn off the monitor for as long as the previous image was displayed, so if an image was on the monitor for 1 hour and there is evidence of a residual or “ghost” image, you should turn off the monitor for 1 hour in order to clear the residual image.

For all LFD products, iiyama recommends displaying moving images and utilising a moving screen saver at regular intervals whenever the screen is idle. You could also turn off the monitor when not in use to assist the prevention.

Other ways to reduce the risk of Image Persistence will be to utilise the FAN-on function (if available), Low Backlight and Low Brightness settings.

## FOR EXTENDED USE AS A PUBLIC MONITOR

### ■ Image Sticking on LCD Panel

When a static image is displayed for hours, an electric charge trace remains near the electrode inside the LCD producing a “ghost” image. (Image Persistence).

Image Persistence is not a permanent feature.

### ■ Recommendations

To prevent Image Sticking and promote longer life expectancy of monitor, we recommend the following:

1. Avoid static images displayed for long periods – change static images on continuous loop.
2. Turn off monitor when not in use, either by remote control or use Standby or Schedule functions.
3. Check the Monitor Menu Settings for "Pixel Shift" etc. and activate it when available. This will reduce the Image Sticking Effect.
4. When monitor is installed in high ambient temperature environment(s) or in an enclosed position, utilise the Cooling Fan, Screen Saver and Low Brightness functions.
5. Suitable ventilation for any monitor is an expectation of any installation – climate control systems may need to be employed.
6. We strongly recommend utilisation of active cooling with fans for long operation times or high ambient temperature environments.

## CUSTOMER SERVICE

### NOTE

- If you have to return your unit for service and the original packaging has been discarded, please contact your dealer or iiyama service center for advice or replacement packaging.

## CLEANING

### WARNING

- If you drop any materials or liquids such as water into the monitor when cleaning, unplug the power cable immediately and contact your dealer or iiyama service center.
- For safety reasons, turn off the power switch and unplug the monitor before you clean it.

### CAUTION

- Do not spray alcohol or disinfectants directly onto the monitor or use them near the monitor. Also, do not wipe the monitor with a cloth or sheet that contains alcohol or disinfectants. These may cause discoloration, deterioration, or cracking of the cabinet, damage to the surface treatment of the Panel, and deterioration of components.
- To avoid potential damage on the monitor (Panel / cabinet / connector terminals) or accessories, never use the following strong solvents or cleaning sheets. These may cause discoloration, deterioration, or cracking of the cabinet, damage to the surface treatment of the Panel, and deterioration of components.

Benzine	Hypochlorous acid water
Thinner	Acidic or alkaline solvents
Alcohol	Wax
Bleach	Abrasives
Peroxide	Office equipment cleaner
Acetone	Glass cleaner
Methylene chloride	Tissue paper
Toluene	Wet tissue
Ammonia	Chemical cloth
Sodium hypochlorite solution (Chlorine bleach)	Cleaning paper
	etc.

### NOTE

- To protect the Touch Panel, do not scratch or rub the screen with a hard object.
- Do not leave the Touch Panel wet. If water droplets or the like get on it, immediately wipe it off with a dry, soft cloth. Leaving it on may cause discoloration or stains on the Touch Panel. In addition, if moisture gets inside the monitor, it may cause damage.
- Touching the cabinet with any product made from rubber or plastic for a long time may cause degeneration or loss of paint on the cabinet.

### Regular care

Gently wipe the cabinet with a soft, dry and clean cloth. If your monitor is particularly dirty, soak the cloth in a mild detergent thoroughly diluted with water, wring it out tightly, and then wipe the dirt off. Then immediately wipe it with a soft, dry cloth.

### Alcohol disinfection

Alcohol disinfection may cause discoloration, deterioration, or cracking of the cabinet, damage to the surface treatment of the Touch Panel, and deterioration of components. Instead, we recommend disinfecting your hands away from the monitor before and after use.

If you absolutely must disinfect the monitor with alcohol, please understand above warnings and cautions in advance. Also, avoid frequent alcohol disinfection.

# BEFORE YOU OPERATE THE MONITOR

## FEATURES

- ◆ Supports Resolutions up to 5120 × 2160
- ◆ High Contrast 5000:1 (Typical: without glass) / Brightness 500cd/m<sup>2</sup> (Typical, panel) : ProLite LH9252UWS-B1AG
- ◆ High Contrast 1200:1 (Typical: without glass) / Brightness 500cd/m<sup>2</sup> (Typical, panel) : ProLite LH10552UWS-B1AG
- ◆ Digital Character Smoothing
- ◆ Automatic Set-up
- ◆ USB C / RJ45 Connectors
- ◆ USB Power Delivery supports up to 100W
- ◆ 2 × 20W Stereo Speakers + 20W subwoofer (Typical)
- ◆ VESA Mounting Standard (800mm×600mm) Compliant : ProLite LH9252UWS-B1AG
- ◆ VESA Mounting Standard (1000mm×600mm) Compliant : ProLite LH10552UWS-B1AG
- ◆ Glass with AG coating

## CHECKING THE CONTENTS OF THE PACKAGE

The following accessories are included in your package. Check to see if they are enclosed with the monitor. If anything is missing or damaged, please contact your local iiyama dealer or regional iiyama office.

- |   |                         |
|---|-------------------------|
| ■ Power Cable*                            | ■ HDMI Cable            |
| ■ Remote Control                          | ■ Battery (2pcs)        |
| ■ Cable ties (For cable management, 5pcs) | ■ Wall mount kit (1set) |
| ■ Mounting bracket for webcam (1set)      | ■ Quick Start Guide     |
| ■ Safety Guide                            |                         |

### CAUTION

- \* All guarantees and warranties are void for any problems or damage caused by a power cable not supplied by iiyama.  
An approved power cable greater or equal to H05VVVF, 3G, 0.75mm<sup>2</sup> must be used.

## UNPACKING

### CAUTION

Moving the monitor requires at least four people, and a dolly cart can be used to move the monitor. If not, it may drop and could result in a serious injury.

## INSTALLATION

### CAUTION

- Follow the manual instructions for the type of mount you have selected. Refer all servicing to qualified service personnel.
- Moving the monitor requires at least two people.
- Before installation, please make sure the wall is strong enough to hold the necessary weight of the display and the mount.

### [WALL MOUNTING]

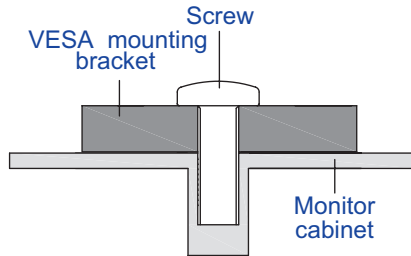

### CAUTION

Use four M8 x 25 mm screws to fix a VESA mounting bracket to the monitor. Make sure that all screws are tightened and secured properly.

When using the wall mounting, consideration of thickness of the VESA mounting bracket needs to be taken. The thickness of the VESA mounting bracket is assumed to be approx. 2.5 mm.

Using a screw longer than this may cause electric shock or damage because it may contact with the electrical parts inside the monitor.

### [ROTATING THE DISPLAY]

The monitor is designed to be compatible with both landscape and portrait modes.

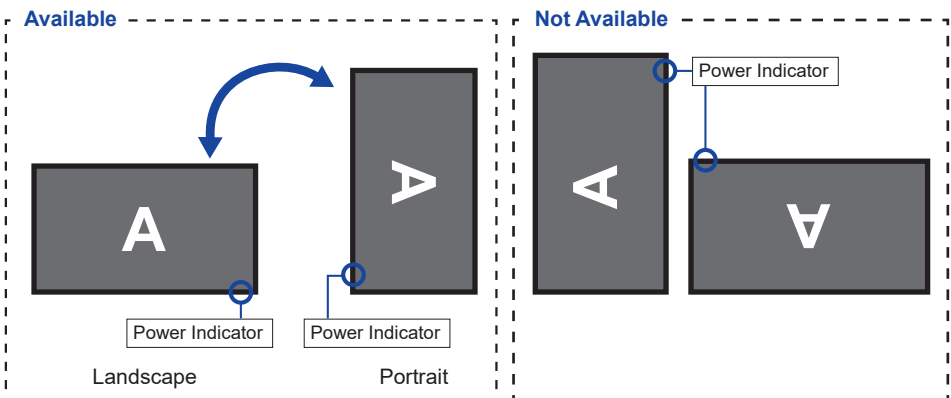

# CONTROLS AND CONNECTORS : MONITOR

<Front>

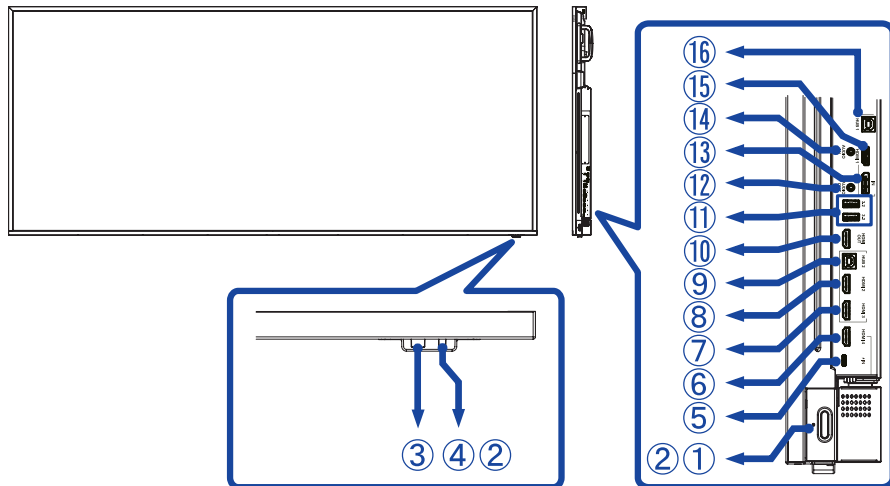

①	Power Button	<b>Power Off</b> Pressing and holding the Power Button on the front for 3-5 seconds.	
②	Power Indicator	Off	Normal Operation
		Red Flashing fast	<b>Standby Mode</b> When the power indicator light is lighting red, the display is in Power Save Mode. To turn the screen back on, you can press the power button on the front or the remote control.
		Red	The Screen Off function is active. To turn the screen back on, you can press any button on the remote control.
		Red Flashing fast	Going to the Standby Mode or system is updating.
③	Remote Sensor		
④	Light Sensor		
⑤	USB C IN	USB C Connector USB3.2 Gen1 (5Gbps,20V $\overline{=}$ 3.25A (with OPS) 20V $\overline{=}$ 5.0A (without OPS)) OPS 18V $\overline{=}$ 3.5A DisplayPort 1.2 ALT model / Power Delivery 65W (with OPS) 100W(without OPS)	
⑥ ⑦ ⑧	HDMI4 IN HDMI3 IN HDMI2 IN	Standard HDMI Connector HDMI2/3/4: HDMI2.0 3840×2160 60Hz HDCP 2.3	
⑨	HUB2 (for HDMI2/HDMI3)	USB Tybe-B Connector USB2.0 (480 Mbps)	

<Front>

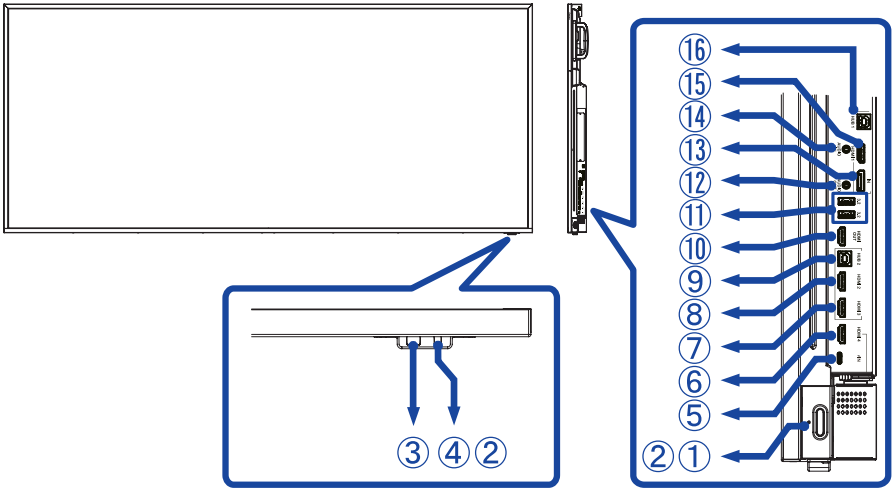

⑩	HDMI OUT	Standard HDMI Connector HDMI2.0 3840×2160 60Hz
⑪	USB3.2	USB Type-A Connector USB3.2 Gen 1 (5Gbps, 5V, 900mA)
⑫	AUDIO OUT	Audio Connector ø 3.5mm TRS mini jack
⑬	DisplayPort IN (5K support)	Standard DisplayPort Connector DisplayPort1.4 5120×2160 60Hz HDCP 2.3
⑭	AUDIO IN	Audio Connector ø 3.5mm TRS mini jack
⑮	HDMI1 IN (5K support)	Standard HDMI Connector HDMI1: HDMI2.0 5120×2160 60Hz HDCP 2.3
⑯	HUB1 (for HDMI1/DisplayPort)	USB Tybe-B Connector USB2.0 (480 Mbps)

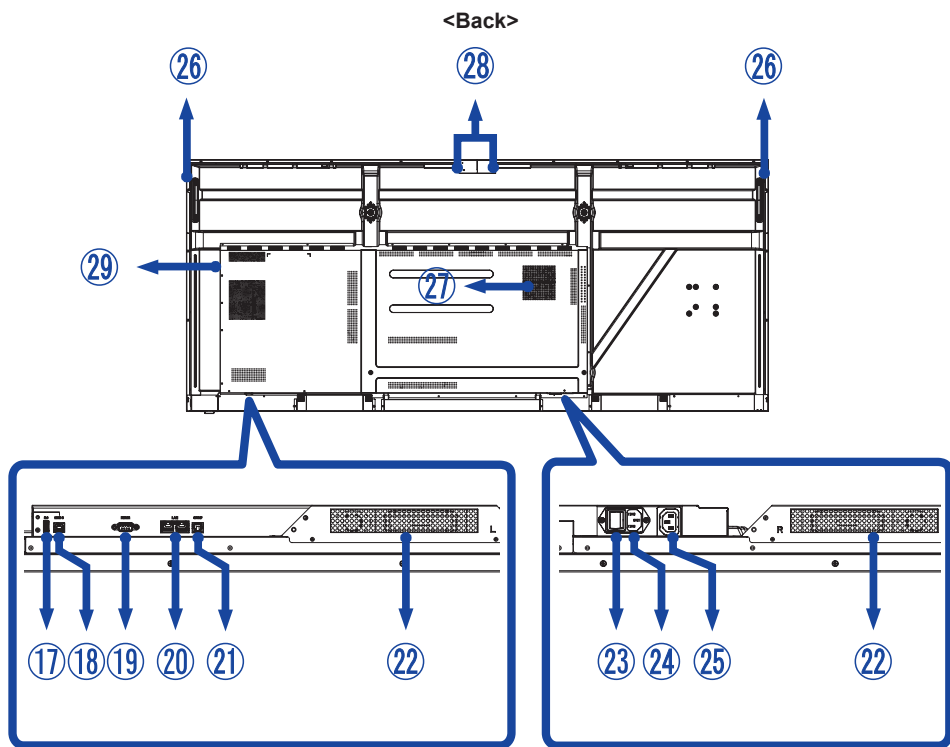

⑰	USB2.0 (for software update)	USB Type-A Connector USB 2.0 (480 Mbps, 5V, 500mA)
⑱	HUB3 (for HDMI4)	USB Type-B Connector USB2.0 (480 Mbps)
⑲	RS232C	DB-9 Connector
⑳	LAN (In/Out auto switching)	RJ45 Gigabit Ethernet
㉑	SPDIF OUTPUT	SPDIF Connector
㉒	Speakers (20W×2)	
㉓	AC SWITCH I (ON) / O (OFF)	Main Power Switch
㉔	AC IN	AC Connector( ~ : Alternating current) (AC-IN)
㉕	AC OUT (250W maximum)	AC Connector (AC-OUT) Only for <b>LH9252UWS-B1AG</b>
㉖	Handles	<b>LH9252UWS</b> x 2, <b>LH10552UWS</b> x 4
㉗	Subwoofer (20W)	
㉘	USB3.2	USB Type-A Connector USB3.2 Gen 1 (5Gbps, 5V, 900mA)
㉙	Option PC module slot	

# FUNCTIONS OF THE REMOTE CONTROL

ENGLISH

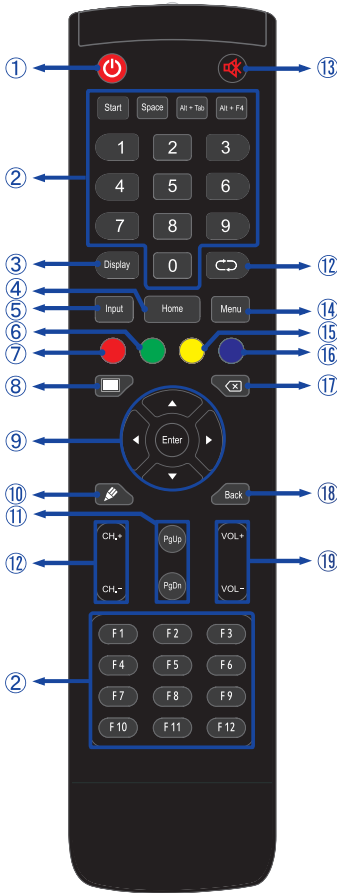

①		Turn the monitor ON and OFF.
②	Number (1-9) / Other / Function (F1-F12)	Under Android: 0-9 numeric input Under Windows: 0-9 numeric input, Start/Space/ALT+Tab/ALT+F4/F1-12 for Keyboard function
③	Display	Provide source and resolution information.
④	Home	Android system main screen button.
⑤	Input	Select the source.
⑥	Green	Lock and unlock remote control - Except power & volume.
⑦	Red	Lock and unlock keypad buttons.
⑧	Screen Off	Turn the backlight On and Off.
⑨		Navigate through submenus and settings. ▲: Up Button ▼: Down Button ◀: Left Button ▶: Right Button
	Enter	Confirm your selection or save changes.
⑩		Quickly start "Writing Software".
⑪	PgUp / PgDn	When select File: The first / Last When Internet browser: Scroll Up / Scroll Down
⑫		Not available on this model.
⑬		Turn on or off the mute function when the Menu is not displayed.
⑭	MENU	Display the "Screen Setting" menu when the Android system is not displayed.
⑮	Yellow	Lock and unlock remote control - All.
⑯	Blue	Lock and unlock system control.
⑰		Backspace
⑱	Back	Return to a previous menu or closes the OSD Menu.
⑲	VOL+ / VOL-	VOL+: Increase the sound volume. VOL-: Decrease the sound volume.

## PREPARING THE REMOTE CONTROL

To use the remote control, insert the two dry batteries.

### CAUTION

- Do not use any other batteries other than those specified in this manual for the Remote Control.
- Do not insert old and new batteries together in the Remote Control.
- Make sure that the terminals match the "+" and "-" indications in the battery compartment.
- Remove the dead batteries immediately to prevent them from liquid leaking into the battery compartment.
- Burst batteries or the electrolyte from these batteries may cause stains, fire or injury.

- ① Open back cover of battery component on the back of remote control.

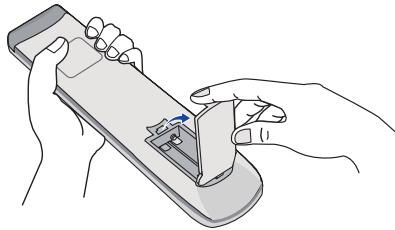

- ② Align and insert two AAA batteries according to their plus and minus ports (as indicated in the remote control).

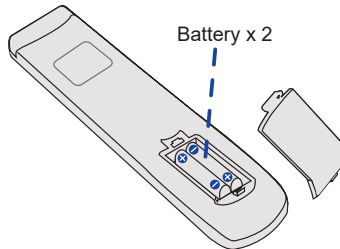

- ③ After battery is installed, close the back cover of battery components, and make the following clip buckled to the bottom.

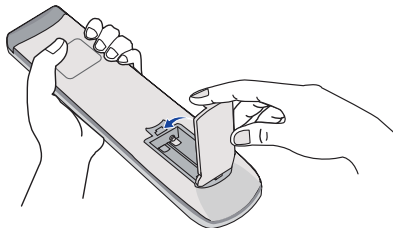

**NOTE**

- Refer to the above instructions when taking out the batteries.
- Replace with new batteries when the Remote Control does not work close to the monitor. Use AAA dry batteries. Risk of explosion if battery is replaced by an incorrect type.
- Operate the Remote Control by pointing it toward the Remote Sensor on the monitor.
- Other manufacturers remote control will not work with this monitor. Use the provided Remote Control ONLY.
- Used batteries needed to follow the city rule to be discarded. (suggestion: to dispose of used batteries please follow correct policy as per your council regulations)
- Batteries shall not be exposed to excessive heat such as sunshine, fire or the like.
- If you do not intend to use the remote control for a long period, remove the batteries.

## BASIC OPERATION

### ■ Turning the monitor ON

The monitor is turned On and the Power Indicator turns to White when you press the Power Button on the monitor or the Remote Control. The monitor is turned Off and the Power Indicator turns to Red when you press the Power Button on the monitor or the Remote Control. Press again to turn On the monitor.

#### NOTE

Even when using the standby mode or turning OFF the Power Switch, the monitor will consume a small amount of electricity. Turn OFF the Power Switch or disconnect the Power Cable from the power supply whenever the monitor is not in use or during the night, to avoid unnecessary power consumption.

[Monitor]

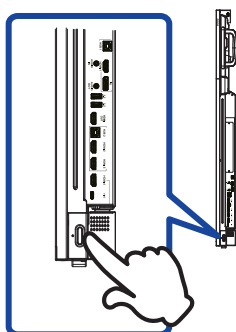

[Remote Control]



### ■ Display the adjustment menu page

The menu page appears on the screen when you press the Menu Button on the Remote Control. The menu page disappears when you press the Back Button on the Remote Control.

[Remote Control]



**■ Move the cursor vertically**

Select adjustment by pressing the ▲ / ▼ Button on the remote control while the menu page is displayed on the screen.

**[Remote Control]****■ Move the cursor horizontally**

Select menu or setting, or perform the adjustment by pressing the ◀ / ▶ Button on the remote control while the menu page is displayed on the screen.

**[Remote Control]**

### ■ Adjust the volume of sound

Press the VOL- / VOL+ Button on the remote control to adjust the volume of sound when the menu page is not displayed on the screen.

#### [Remote Control]



### ■ Switch the input signal

The Input setting menu appears on the screen when you press the Input Button on the remote control.

#### [Remote Control]



## CONNECTING YOUR MONITOR

- ① Ensure that both the computer and the monitor are switched off .
- ② Connect the computer to the monitor with the signal cable.
- ③ Connect the computer to the monitor with the USB Cable.
- ④ Connect the Power Cable to the monitor first and then to the power source.
- ⑤ Turn on your monitor (Main Power Switch and Power Button) and computer.

### NOTE

- Make sure that the building installation has a circuit breaker of 120/240V, 20A (maximum).
- The signal cables used for connecting the computer and monitor may vary with the type of computer used. An incorrect connection may cause serious damage to both the monitor and the computer. The cable supplied with the monitor is for a standard connector. If a special cable is required please contact your local iiyama dealer or regional iiyama office.
- The Class I pluggable equipment Type A must be connected to protective earth.
- The socket-outlet shall be installed near the equipment and shall be easily accessible.
- Excessive sound pressure from ear-/headphones can cause hearing damage/hearing loss.

[ Example of Connection ]

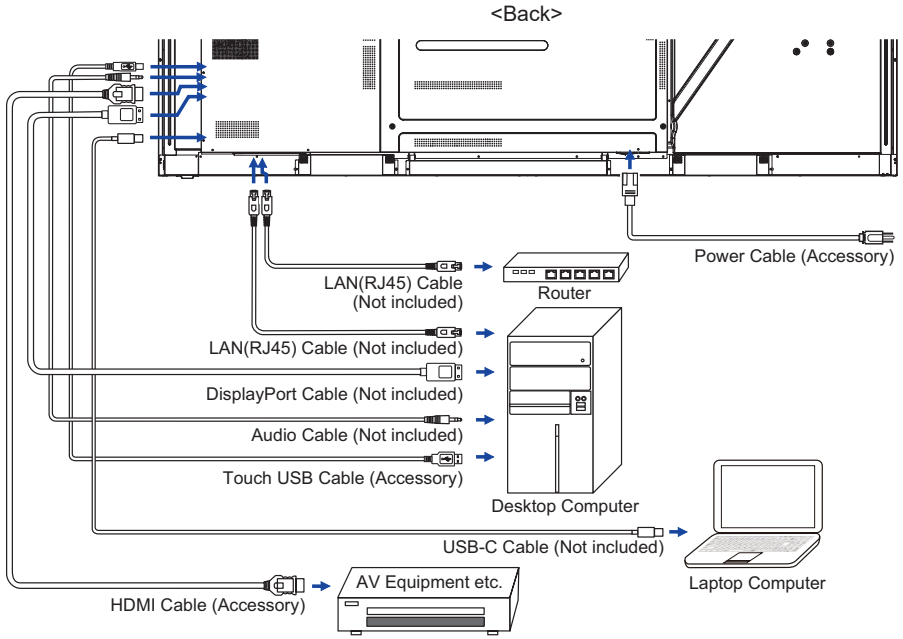

## [ Connection example with the peripheral device ]

### CAUTION

Turn off the power switch and unplug the monitor and peripherals before connection to avoid an electric shock or a damage.

### NOTE

- Refer to the user manual of peripherals at the same time.
- Ensure you have the necessary cables as required.

ENGLISH

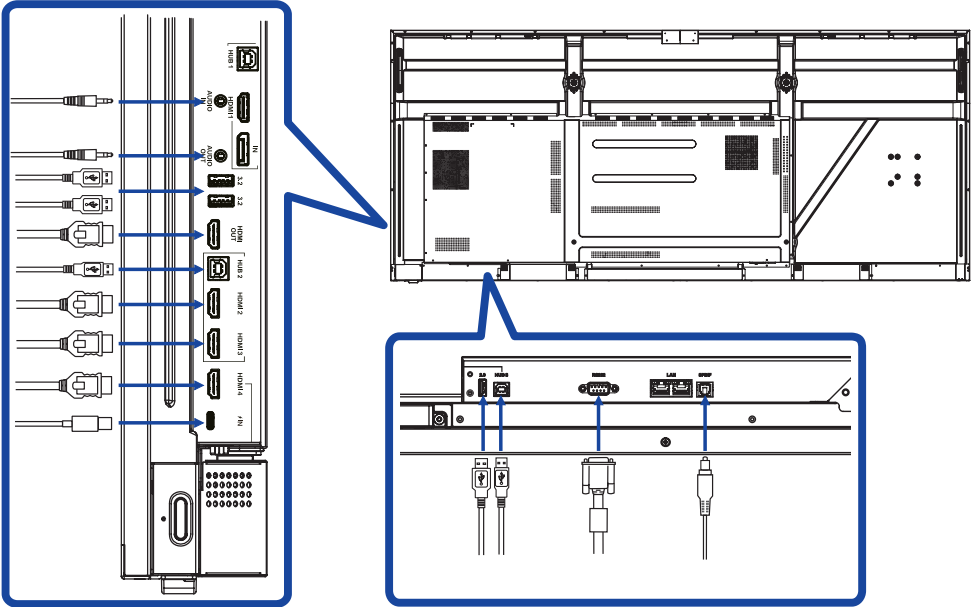

## [ To setup the network ]

1. Switch on the router and switch on its DHCP setting.
2. Connect the router to this monitor with an Ethernet cable.
3. Press  HOME button and 1668 on the remote control, then select Settings.
4. Select "Network & internet", then press OK button.
5. Select "Ethernet", then press OK button.
6. Follow the on-screen instructions to install the network.

**NOTE** Connecting with a shielded CAT-5 Ethernet cable to comply with the EMC directive.

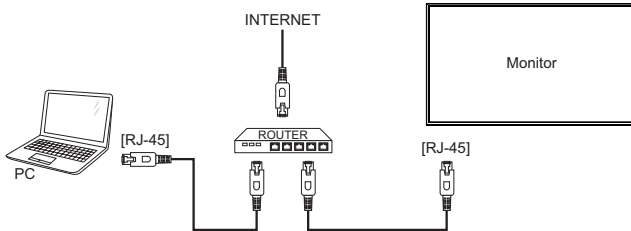

## COMPUTER SETTING

### ■ Signal Timing

Change to the desired signal timing listed on page 42: COMPLIANT TIMING.

# OPERATING THE MONITOR

To create the best picture, your iiyama LCD monitor has been preset at the factory with the COMPLIANT TIMING shown on page 42. You are also able to adjust the picture by following the button operation shown below.

- ① To open the source menu, simply press the **INPUT** button on the remote control, or click **...** on Common settings menu with remote control. There are additional Menu items which can be switched by using the **▲ / ▼ / ◀ / ▶** buttons on the remote control.

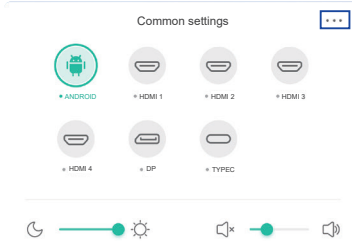

- ② Select the Menu item of the adjustment you want to make. Press the **ENTER** button on the remote control to enter the menu page. Then, use the **▲ / ▼** buttons on the remote control to highlight the desired adjustment item.
- ③ Use the **◀ / ▶** buttons on the remote control to make the appropriate adjustment or setting.
- ④ Press the **BACK** button on the remote control to leave the menu, and the settings you just made would be automatically saved.

For example, to correct for brightness, select Menu item of "Display settings". Select "Brightness" by using the **◀ / ▶** Buttons on the remote control.

Use the **◀ / ▶** Buttons on the remote control to change the brightness settings. The brightness of the overall display should be changing accordingly while you are doing this.

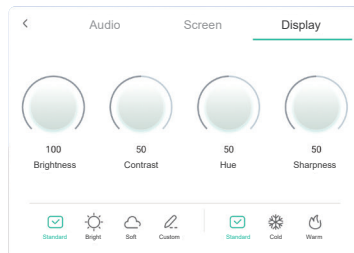

Press the Back Button on the remote control, all changes are saved in the memory.

## NOTE

- The Back Button on the remote control can be used to return previous menu item.
- Any changes are automatically saved in the memory when the On Screen Display disappears. Turning off the power should be avoided while using the Menu.
- Adjustments for Image Position and Phase are saved for each signal timing. Except for these adjustments, all other adjustments have only one setting which applies to all signal timings.

## ADJUSTMENT MENU CONTENTS

### Common settings

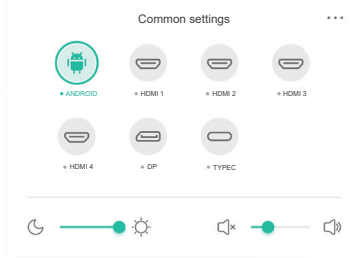

Adjustment Item	Problem / Option		Button to Press
Input * <sup>1</sup> <b>Direct</b>	Android	Select the Android input.	
	HDMI1	Select the HDMI1 input.	
	HDMI2	Select the HDMI2 input.	
	HDMI3	Select the HDMI3 input.	
	HDMI4	Select the HDMI4 input.	
	DP	Select the DisplayPort input.	
	Type-C	Select the Type-C input.	
	PC * <sup>2</sup>	Select the PC input.	
Volume <b>Direct</b>	Too soft		⬅️ ➡️
	Too loud		⬅️ ➡️
Backlight <b>Direct</b>	Brightness of backlight is reduced.		⬅️ ➡️

\*<sup>1</sup> The switching of the signal input take a few seconds.

\*<sup>2</sup> Available when Slot-PC is installed only.

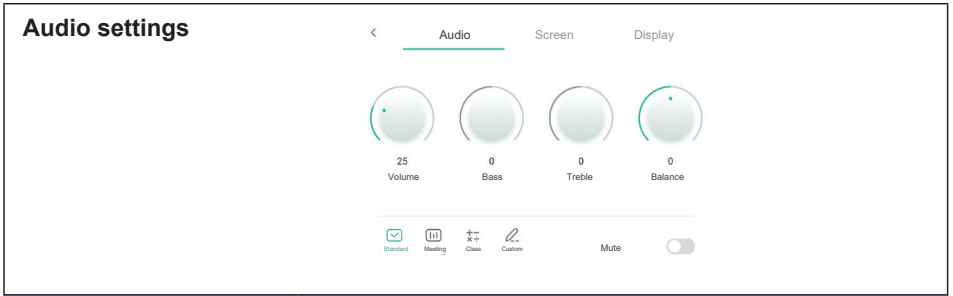

Adjustment Item	Problem / Option		Button to Press
Volume <b>Direct</b>	Too soft		▶▶
	Too loud		◀◀
Bass	Too weak		▶▶
	Too strong		◀◀
Treble	Too weak		▶▶
	Too strong		◀◀
Balance	Left side speaker louder		▶▶
	Right side speaker louder		◀◀
Sound Mode	Standard	Standard	
	Meeting	Sound quality suitable for the conference.	
	Class	Sound quality suitable for the classroom.	
	Custom	Custom sound quality.	
Mute <b>Direct</b>	○	Return the sound volume to the previous level.	
		Turn off the sound.	

## Screen settings

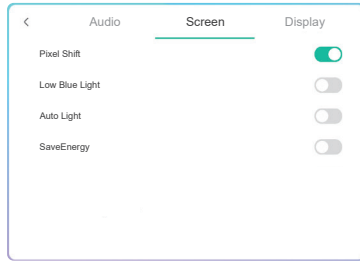

Adjustment Item	Problem / Option		Button to Press
Pixel Shift	<input type="radio"/>	The screen image will move around slightly every 2 minutes.	
		Pixel Shift is turned off.	
Low Blue Light	<input type="radio"/>	Blue light is reduced.	
		Low Blue Light is turned off.	
Auto Light	<input type="radio"/>	The image brightness can be automatically adjusted according to the ambient light.	
		Auto Light is turned off.	
SaveEnergy	<input type="radio"/>	Enhanced SaveEnergy	
		SaveEnergy is turned off.	

## Display settings

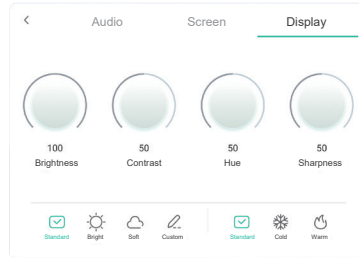

Adjustment Item	Problem / Option		Button to Press
Brightness* <sup>1</sup>	Too dark		▶▶
	Too bright		◀◀
Contrast	Too dull		▶▶
	Too intense		◀◀
Hue	Not available for this model.		
Sharpness	Not available for this model.		
Display Mode * <sup>2</sup>	Standard	For general windows environment and monitor default setting.	
	Bright	Enlarge brightness and vivid.	
	Soft	Reduce brightness and soften.	
	Custom	Displays a picture on a screen set by Image Settings adjustments.	
Color Temp	Standard	Normal color	
	Cold	Cool color	
	Warm	Warm color	
	Blue Light Reducer	Blue light is reduced. (Custom)	

\*<sup>1</sup> Adjust the Brightness when you are using the monitor in a dark room and feel the screen is too bright.

\*<sup>2</sup> Display Mode is disabled when Android input.

## [Application]

### ■ Settings

Click  with the Remote Control.



### ■ Status bar

 : Click to display the Ethernet settings.

 : Displayed when WiFi module is inserted. Click to display the WiFi Settings.

 : Displayed when WiFi module is inserted. Click to display the Hotspot settings.

 : Displayed when USB flash drive is connected. Click to access your USB flash drive in the Finder application.

09:28(Clock) : Click on the clock display to display the Date & Time of Settings.

 xxxxxx :

When connecting a LAN or Option WiFi module, the password for a notebook or a smartphone, etc. to connect to iiyama Share, is displayed on the screen. (Automatically generated)

[  Settings ]

Adjustment Item	Problem / Option		
Wireless & Network	WiFi* <sup>1,2</sup>	Set the WiFi function On / Off and pairing to WiFi device.	
	Ethernet	Set the wired network. Ethernet : On / Off, Obtain IP Address Automatically : On / Off, IP address, Default gateway, Netmask, DNS, Proxy	
	Hotspot* <sup>1,2</sup>	Set the Hotspot function. Hotspot : On/Off, Hotspot Name, Password	
	Bluetooth* <sup>1</sup>	Set the Bluetooth function On / Off and pairing to Bluetooth device.	
	VPN	Set the VPN.	
	Share Network	Share Network to connected device via USB cable.	
	Hostname	Set the Hostname.	
Personal	Wallpaper	Set the Wallpaper. (Stills, Dynamic) Wallpaper Logo : On / Off	
Input & Output	Sound	Touch Sounds : On / Off Sound Output Settings : Speaker / Lineout / Mixed	
	Input settings	Input Naming Settings Input Alias Switch : On / Off Change the Input name to Nickname.	
	External Source Display settings	HDMI OUT Format :	3840 × 2160_60Hz / 1080P_60Hz / 480P_60Hz / AUTO OPS Output Format : Auto / MIPI(5120x2160) / HDMI
		HDMI CEC	Set the HDMI CEC function On/Off.
		Advanced HDMI Settings	Set the HDMI2 / HDMI3 / HDMI4.
		Wake On Lan	Set the Wake On Lan function On/Off.
Auto Source Switching	When the system is running and a new signal source is connected, it will automatically switch to display the new input.		
Application	Application management Default apps, Unused apps, Special app access		
System	Date & Time	Set the Date and Time. Use 24-Hour Format, Automatic Date & Time, Date Format, Time zone	
	Language & Keyboard	Set display language, keyboard and input method. Language: Catala / Čeština / Dansk / Deutsch / English / Español / Français / Magyar / Italiano / Lietuvių / Latviešu / Norsk Bokmål / Nederlands / Polski / Русский / Svenska / Українська	
	Settings lock Password	Set the password. (4-digit) Set password, Change password	

System	Startup & shutdown	Startup channel	Last shutdown channel / Android / HDMI1 / HDMI2 / HDMI3 / HDMI4 / DP / TYPEC 1 / TYPEC 2 / PC*3		
		Standby after startup (black screen) : Turn off the backlight. <b>NOTE</b> Press the Screen Off button on the remote control or touch the screen to return to the screen.			
		Default Startup Item	Select Startup Item (None / URL Browser / Browser / iiyama Account / iiyama DMS / Cloud Drive / ESharePro / Finder /iMirror / Keeper / Note / Palette / PIP / Settings / Visualizer / WPS Office)		
		Kiosk Mode	Set the Kiosk Mode On/Off.		
		Energy Saving	Auto Power off : Enable the Auto power off function. (Never / 30 mins / 60 mins / 90mins / 120 mins / 240 mins) <b>NOTE</b> The Auto Power off function is enabled as default setting. The monitor turns off automatically 4 hours after the key or touch operation stops. Disable Auto Power off function when you use the monitor continuously for more than 4 hours.		
		Timer Switch	Power off reminder : On / Off		
	Add Boot Task		Select the time of each, and select day of the week or everyday or the business days.		
	Add Off Task				
	Screen orientation	Set the landscape portrait modes function.			
	Pixel Shift	Set the interval of Pixel Shift function On/Off.			
	Storage	To display the internal system and USB disk.			
	System update	Check and update to latest FirmWare version.			
	Advance Settings	Install unknown apps function On/Off.			
		Enable USB Drive function On/Off.			
		Remote Control Lock function On/Off.			
		Keypad Lock function On/Off.			
		System Lock			
		Reset Factory			
		Meeting Room Mode function On/Off.			
Security	Export Logcat				
	Auto Remove Files	Storage period (None / 1day / 7days / 30days)			
	Security lock	Disable / Enable (Settings Lock / Network Lock / USB Lock / Unknown Source*4)			

[  Settings ]

System	USB Clone	Import	Import from signage folder under USB/SD. USB storage / SD card
		Export	Export to signage folder under USB/SD. USB storage / SD card
About	Main info in About: Legal Information / Module Number / Android Version / Kernel Version / Build number / Firmware Version / Serial Number / Developer Options / Compliance Version Automatically search update .zip from USB or SD card. When you select the updated .zip file, the monitor will restart and the update will start.		

- \*1 WiFi, Hotspot and Bluetooth can only be used when Option WiFi Module or Slot-PC is installed.
- \*2 WiFi will be turned off when the Ethernet is turned on.
- \*3 Available only when Option Slot-PC is installed.
- \*4 APK from unknown sources can be installed, the installation is done on customer own risk, manufacture will not take any responsibility and not give any support for the installed APK's.  
Input + 1379 (Debug Menu : Unknown sources)

## [Finder (File Browser)]

Click  with the Remote Control.

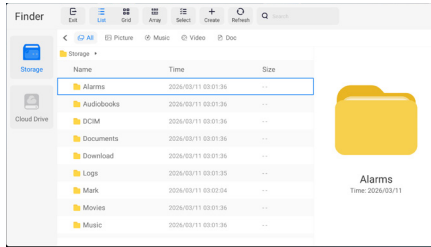

Browse the files stored in the internal storage device, the USB storage, Public Cloud, Remote File and your Cloud storage.

### ● Supported Format

DOC : PPT, Word, Excel, PDF (Open the file by using the WPS Office)

Note : Note files, screenshot

Movie : .3g2 .3gp .avi .flv .f4v .mkv .mov .mp4 .VOB .mpg/.MPEG .ts

Picture : .jpg .jpeg .png .bmp .gif

Music : .aac .ape .flac .m4a .mp3 .ogg .wav

### My Files

"My files" folder will be created in your OneDrive or Google Drive once connected to your iiyama account.

### Public Cloud (Google Drive / One Drive)

#### Save to Cloud Drive

Users can save notes and annotations in Note directly to one of the cloud drives by clicking on the Cloud Storage icon in the menu. To change the way files are saved to the Cloud Drive, users can select two options in the cloud storage overview.

#### Use the default account

When checked, all notes will be saved automatically to the default Cloud Drive. Users will not be able to select a cloud drive.

#### Use the default file name when save

When checked, all notes will be saved to the selected Cloud Drive with the default file name. Users will not be able to (re)name the file.

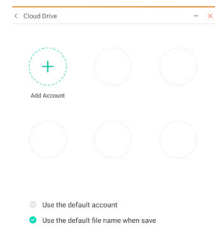

### Remote File

Support access to SAMBA(SMB1.0) and FTP server.

**[Browser (Web Browser)]**

Connect the network, and browse the web.

Click  with the remote control.

**[iiyama DMS]**

This software provides organizations with a convenient and fast unified management solution for terminal equipment, builds an efficient and real-time equipment management system, helps digitize the campus environment and makes campus management more convenient.

Click  with the remote control.

**[iiyama Share]**

This is the software that can wirelessly share the screen with other notebook etc..

Click  with the remote control.

**[QuickSupport]**

TeamViewer QuickSupport mobile app allows you to quick receive remote support on your smartphone or tablet.

Click  with the remote control.

**[Finder]**

Browse the files stored in the internal storage device, the USB storage, Public Cloud, Remote File and your Cloud storage.

Click  with the remote control.

**[Media Player]**

Click  with the remote control.

**[Cloud Drive]**

Connect the network, and the Cloud Drive.

Click  with the remote control.

**[Host]**

The TeamViewer Host app for Android allows for remote control of unattended Android devices. A connection is possible even when the device is not being actively used.

Click  with the remote control.

## STANDBY FEATURE

### ■ Standby Mode

When the video signal from the computer is off, the monitor enters into Standby Mode which reduces the power consumption to less than 0.5W\*. The screen becomes dark, and the power indicator turns to red. From Standby Mode, the image reappears in several seconds when the source input reconnected.

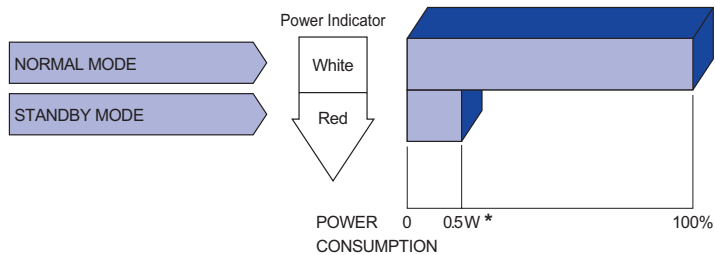

\* When the USB devices are not connected.

# TROUBLE SHOOTING

If the monitor fails to operate correctly, please follow the steps below for a possible solution.

1. Perform the adjustments described in OPERATING THE MONITOR, depending on the problem you have. If the monitor does not get a picture, skip to 2.
2. Consult the following items if you cannot find an appropriate adjustment item in OPERATING THE MONITOR or if the problem persists.
3. If you are experiencing a problem which is not described below or you cannot correct the problem, discontinue using the monitor and contact your dealer or iiyama service center for further assistance.

Problem		Check
①	The picture does not appear.	
	(Power indicator does not light up.)	<input type="checkbox"/> The Power Cable is firmly seated in the socket. <input type="checkbox"/> The Power Button is turned ON. <input type="checkbox"/> The AC socket is live. Please check with another piece of equipment.
	(Power indicator is white.)	<input type="checkbox"/> If the blank screen saver is in active mode, touch the keyboard or the mouse. <input type="checkbox"/> Increase the Contrast and/or Brightness. <input type="checkbox"/> The computer is ON. <input type="checkbox"/> The Signal Cable is properly connected. <input type="checkbox"/> The signal timing of the computer is within the specification of the display.
	(Power indicator is red.)	<input type="checkbox"/> The computer is ON. <input type="checkbox"/> The Signal Cable is properly connected. <input type="checkbox"/> The signal timing of the computer is within the specification of the display.
②	The screen is not synchronized.	<input type="checkbox"/> The Signal Cable is properly connected. <input type="checkbox"/> The signal timing of the computer is within the specification of the monitor.
③	The screen position is not in the center.	<input type="checkbox"/> The signal timing of the computer is within the specification of the monitor.
④	The screen is too bright or too dark.	<input type="checkbox"/> The video output level of the computer is within the specification of the monitor.
⑤	The screen is shaking.	<input type="checkbox"/> The power voltage is within the specification of the monitor. <input type="checkbox"/> The signal timing of the computer is within the specification of the monitor.
⑥	No sound.	<input type="checkbox"/> The audio equipment (computer etc.) is ON. <input type="checkbox"/> The Audio Cable is properly connected. <input type="checkbox"/> The Volume is turned up. <input type="checkbox"/> The Mute is OFF. <input type="checkbox"/> The audio output level of the audio equipment is within the specification of the monitor.
⑦	The sound is too loud or too quiet.	<input type="checkbox"/> The audio output level of the audio equipment is within the specification of the monitor.
⑧	A strange noise is heard.	<input type="checkbox"/> The Audio Cable is properly connected.

# RECYCLING INFORMATION

For better environment protection please don't dispose your monitor.  
Please visit our web site: <https://iiyama.com> for monitor recycling.

# APPENDIX

Design and specifications are subject to change without prior notice.

## SPECIFICATIONS : ProLite LH9252UWS-B1AG

Size Category	92"	
LCD Panel	Panel technology	VA
	Size	Diagonal: 92" (233cm)
	Pixel pitch	0.13945mm H × 0.41835mm V
	Brightness	500cd/m <sup>2</sup> (Typical), 300cd/m <sup>2</sup> (Default / Energy Saving)
	Contrast ratio	5000 : 1 (Typical)
	Viewable angle	Horizontal : 89 degrees, Vertical: 89 degrees (Typical)
	Response time	6.5ms (Typical, Gray to Gray)
Display Colors	Approx. 1.07B	
Sync Frequency	HDMI1/2/3/4: Horizontal: 30.0-135.0kHz, Vertical: 24-60Hz DisplayPort: Horizontal: 23.97-135.0kHz, Vertical: 24-30Hz USB-C IN: Horizontal: 30.0-135.0kHz, Vertical: 24-60Hz	
Native Resolution	5120 × 2160, 11.06 MegaPixels	
Supported max. resolution	HDMI2/3/4: 3840 × 2160 60Hz (YUV420/RGB444/YUV444) DisplayPort/HDMI1: 5120 × 2160 60Hz USB C IN: 3840 × 2160 60Hz	
Input Connector	HDMI ×4, DisplayPort ×1, USB-C ×1	
USB Standard	USB2.0 (DC5V, 500mA) ×1 (for software update) USB3.2 Gen1 (5Gbps, 5V, 900mA) ×4 (Side: 2, Top: 2) USB C (3.2 Gen 1 5Gbps, 5V, 3A / 9V, 3A / 15V, 3A / 20V, 3.25A / 20V, 5A) ×1 (DisplayPort 1.2 ALT mode/Power Delivery 100W*1)	
Number of USB Ports Connector shape	1 : USB C 3 Upstream : Type B 5 Downstream : Type A	
Input Audio Connector	ø 3.5mm mini jack (Stereo)	
LAN	RJ45 ×2 (in/out)	
Serial Port	RS-232C In	
Input Sync Signal	Separate sync: TTL, Positive or Negative	
Input Video Signal	HDMI, DisplayPort, USB C (DisplayPort 1.2)	
Input Audio Signal	2.0Vrms maximum	

Output Connector	HDMI 3840 × 2160 60Hz
SPDIF out Connector	SPDIF
Output Audio connector	ø 3.5mm mini jack (Stereo)
Speakers	Internal: 20W ×2 (Stereo speakers) + 20W (Subwoofer)
Android Version	V11.0 (Android 13.0 OS)
Maximum Screen Size	2141.952mm W × 903.636mm H / 84.3" W × 35.6" H
Power Source	AC Input: 100-240Vac, 50/60Hz, 8.5A AC Output: 100-240Vac, 50/60Hz, Max. 250W
Power Consumption* <sup>2</sup>	201W (Default / Energy Saving) Standby Mode: 0.5W maximum, Off mode: 0.3W maximum
Dimensions / Net Weight	2182.0 × 944.0 × 85.0mm / 85.9 × 37.1 × 3.3" (W×H×D) 42.5kg / 93.6lbs
Environmental Considerations	Operating: Temperature 0 to 40°C / 32 to 104°F Humidity 10 to 90% (No condensation) Storage: Temperature -20 to 60°C / 4 to 140°F Humidity 10 to 90% (No condensation)
Approvals	CE, UKCA, EAC, TÜV-Bauart

**NOTE** \*<sup>1</sup> Only available when the OPS is unplugged; otherwise it will back to 65W.  
It needs a full-function type C-C cable with EMARK certification.

\*<sup>2</sup> When the USB devices are not connected.

## SPECIFICATIONS : ProLite LH10552UWS-B1AG

Size Category	105"	
LCD Panel	Panel technology	IPS
	Size	Diagonal: 104.6" (265.68cm)
	Pixel pitch	0.14355mm H × 0.14355mm V
	Brightness	500cd/m <sup>2</sup> (Typical), 300cd/m <sup>2</sup> (Default / Energy Saving)
	Contrast ratio	1200 : 1
	Viewable angle	Horizontal : 89 degrees, Vertical: 89 degrees (Typical)
	Response time	8ms (Typical, Gray to Gray)
Display Colors	Approx. 1.07B	
Sync Frequency	HDMI1/2/3/4: Horizontal: 30.0-135.0kHz, Vertical: 24-60Hz DisplayPort: Horizontal: 23.97-135.0kHz, Vertical: 24-30Hz USB-C IN: Horizontal: 30.0-135.0kHz, Vertical: 24-60Hz	
Native Resolution	5120 × 2160, 11.06 MegaPixels	
Supported max. resolution	HDMI2/3/4: 3840 × 2160 60Hz (YUV420/RGB444/YUV444) DisplayPort/HDMI1: 5120 × 2160 60Hz USB-C IN: 3840 × 2160 60Hz	
Input Connector	HDMI ×4, DisplayPort ×1, USB-C ×1	
USB Standard	USB2.0 (DC5V, 500mA) ×1 (for software update) USB3.2 Gen1 (5Gbps, 5V, 900mA) ×4 (Side: 2, Top: 2) USB C (3.2 Gen 1 5Gbps, 5V, 3A / 9V, 3A / 15V, 3A / 20V, 3.25A / 20V, 5A) ×1 (DisplayPort 1.2 ALT mode/Power Delivery 100W <sup>*1</sup> )	
Number of USB Ports Connector shape	1 : USB C 3 Upstream : Type B 5 Downstream : Type A	
Input Audio Connector	ø 3.5mm mini jack (Stereo)	
LAN	RJ45 ×2 (in/out)	
Serial Port	RS-232C In	
Input Sync Signal	Separate sync: TTL, Positive or Negative	
Input Video Signal	HDMI, DisplayPort, USB C (DisplayPort 1.2)	
Input Audio Signal	2.0Vrms maximum	

Output Connector	HDMI 3840 × 2160 60Hz
SPDIF out Connector	SPDIF
Output Audio connector	ø 3.5mm mini jack (Stereo)
Speakers	Internal: 20W ×2 (Stereo speakers) + 20W (Subwoofer)
Android Version	V11.0 (Android 13.0 OS)
Maximum Screen Size	2449.92mm W × 1033.56mm H / 96.5" W × 40.7" H
Power Source	100-240VAC, 50/60Hz Input: 7.0A
Power Consumption* <sup>2</sup>	248W (Default / Energy Saving) Standby Mode: 0.5W maximum, Off mode: 0.3W maximum
Dimensions / Net Weight	2490.0 × 1074.0 × 77.0mm / 98.0 × 42.2 × 3.0" (W×H×D) 53.0kg / 116.8lbs
Environmental Considerations	Operating: Temperature 0 to 40°C / 32 to 104°F Humidity 10 to 90% (No condensation) Storage: Temperature -20 to 60°C / 4 to 140°F Humidity 10 to 90% (No condensation)
Approvals	CE, UKCA, EAC, TÜV-Bauart

**NOTE**

\*<sup>1</sup> Only available when the OPS is unplugged; otherwise it will back to 65W.  
It needs a full-function type C-C cable with EMARK certification.

\*<sup>2</sup> When the USB devices are not connected.

## DIMENSIONS : ProLite LH9252UWS

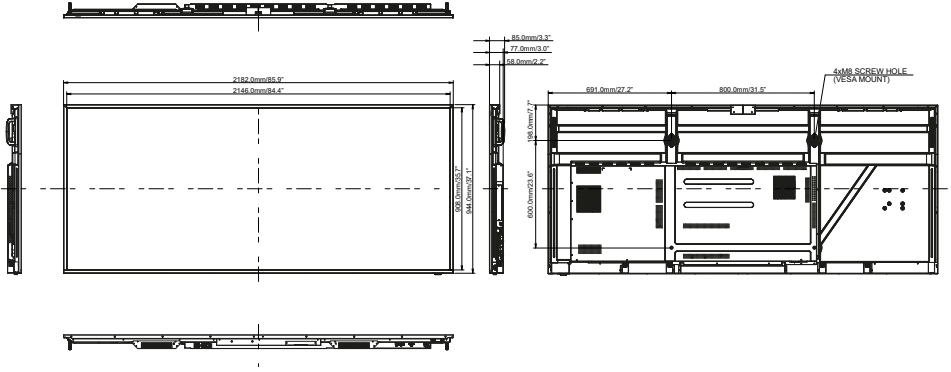

ENGLISH

## DIMENSIONS : ProLite LH1052UWS

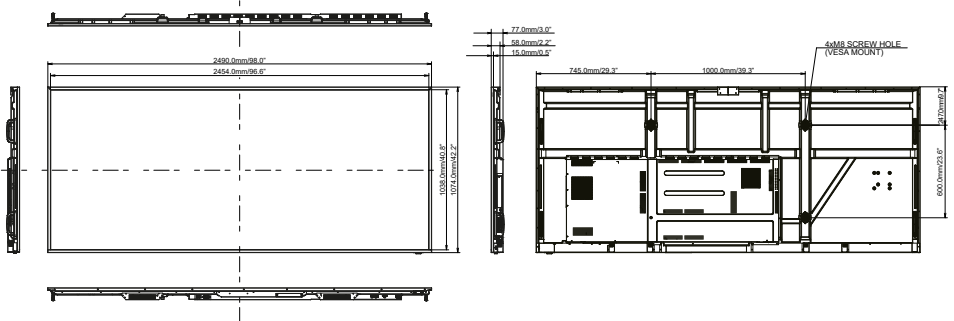

# COMPLIANT TIMING

Timing		fH(kHz)	fV(Hz)	Dot clock (MHz)	HDMI1	HDMI2	HDMI3	HDMI4	DisplayPort	Type C1	Type C2
VESA	640x480	60Hz	31.5	59.9	25.180	○	○	○	○	○	○
	800x600	56Hz	35.2	56.3	36.000	○	○	○	○	○	○
	800x600	60Hz	37.9	60.3	40.000	○	○	○	○	○	○
	1024x768	60Hz	48.4	60.0	65.000	○	○	○	○	○	○
	1280x768	60Hz	47.8	59.9	79.500	○	○	○	○	○	○
	1280x800	60Hz	49.7	59.8	83.500	○	○	○	○	○	○
	1280x960	60Hz	60.0	60.0	108.000	○	○	○	○	○	○
	1280x1024	60Hz	64.0	60.0	108.000	○	○	○	○	○	○
	1360x768	60Hz	47.7	60.0	85.500	○	○	○	○	○	○
	1366x768	60Hz	47.7	59.8	85.500	○	○	○	○	○	○
	1400x1050	60Hz	65.3	60.0	121.750	○	○	○	○	○	○
	1600x1200	60Hz	75.0	60.0	162.000	○	○	○	○	○	○
	1680x1050	60Hz	65.3	60.0	146.250	○	○	○	○	○	○
	1920x1200	60Hz	74.6	59.9	193.250	○	○	○	○	○	○
CVT	1280x720	60Hz	45.0	60.0	74.250	○	○	○	○	○	○
	1440x900	60Hz	55.9	59.9	106.500	○	○	○	○	○	○
	3440x1440	30Hz	44.0	30.0	196.250	○	○	○	○	○	○
	3440x1440	50Hz	74.1	50.0	344.000	○	○	○	○	○	○
	3440x1440	60Hz	89.5	59.9	419.500	○	○	○	○	○	○
CVTRB	1600x900	60Hz	60.0	60.0	108.000	○	○	○	○	○	○
CEA	640x480	60Hz	31.5	60.0	25.200	○	○	○	○	○	○
	720x480	60Hz	31.5	60.0	27.027	○	○	○	○	○	○
	1280x720	60Hz	45.0	60.0	74.250	○	○	○	○	○	○
	1920x1080	30Hz	33.8	30.0	74.250	○	○	○	○	○	○
	1080i	60Hz	33.8	60.0	74.250	○	○	○	○	○	○
CTA	1920x1080	60Hz	67.5	60.0	148.500	○	○	○	○	○	○
	3840x2160	24Hz	54.0	24.0	297.000	○	○	○	○	○	○
	3840x2160	25Hz	56.3	25.0	297.000	○	○	○	○	○	○
	3840x2160	30Hz	67.5	30.0	297.000	○	○	○	○	○	○
	3840x2160	50Hz	112.5	50.0	594.000	○	○	○	○	○	○
	3840x2160	60Hz	135.0	59.9	594.000	○	○	○	○	○	○
	5120x2160	30Hz	66.0	30.0	396.000	○	○	○	○	○	○
5120x2160	50Hz	112.5	50.0	742.500	○	○	○	○	○	○	
5120x2160	60Hz	135.0	60.0	742.500	○	○	○	○	○	○	
IBM	720x400		31.5	70.0	28.320	○	○	○	○	○	○
SD	480i	60Hz	15.7	60.0	27.000	○	○	○	○	○	○
	576i	50Hz	15.6	50.0	13.500	○	○	○	○	○	○
	480p	60Hz	31.5	60.0	27.000	○	○	○	○	○	○
	576p	50Hz	31.3	50.0	27.000	○	○	○	○	○	○
HD	720p	50Hz	37.5	50.0	27.000	○	○	○	○	○	○
		60Hz	45.0	60.0	74.250	○	○	○	○	○	○
	1080i	50Hz	28.1	50.0	74.250	○	○	○	○	○	○
		60Hz	33.7	60.0	74.250	○	○	○	○	○	○
	1080p	50Hz	56.3	50.0	148.500	○	○	○	○	○	○
		60Hz	67.5	60.0	148.500	○	○	○	○	○	○

\* ○ means supported the timing.